

Any queries on the precise location and alignment of any right of way must be made to the Definitive Map team at Nottinghamshire County Council.

© Crown copyright and database right 2012. Ordnance Survey Licence number 100019517.

Z:\Site Allocations\Transport\Retford South.mxd Initials LJP GIS Team 09/10/2012

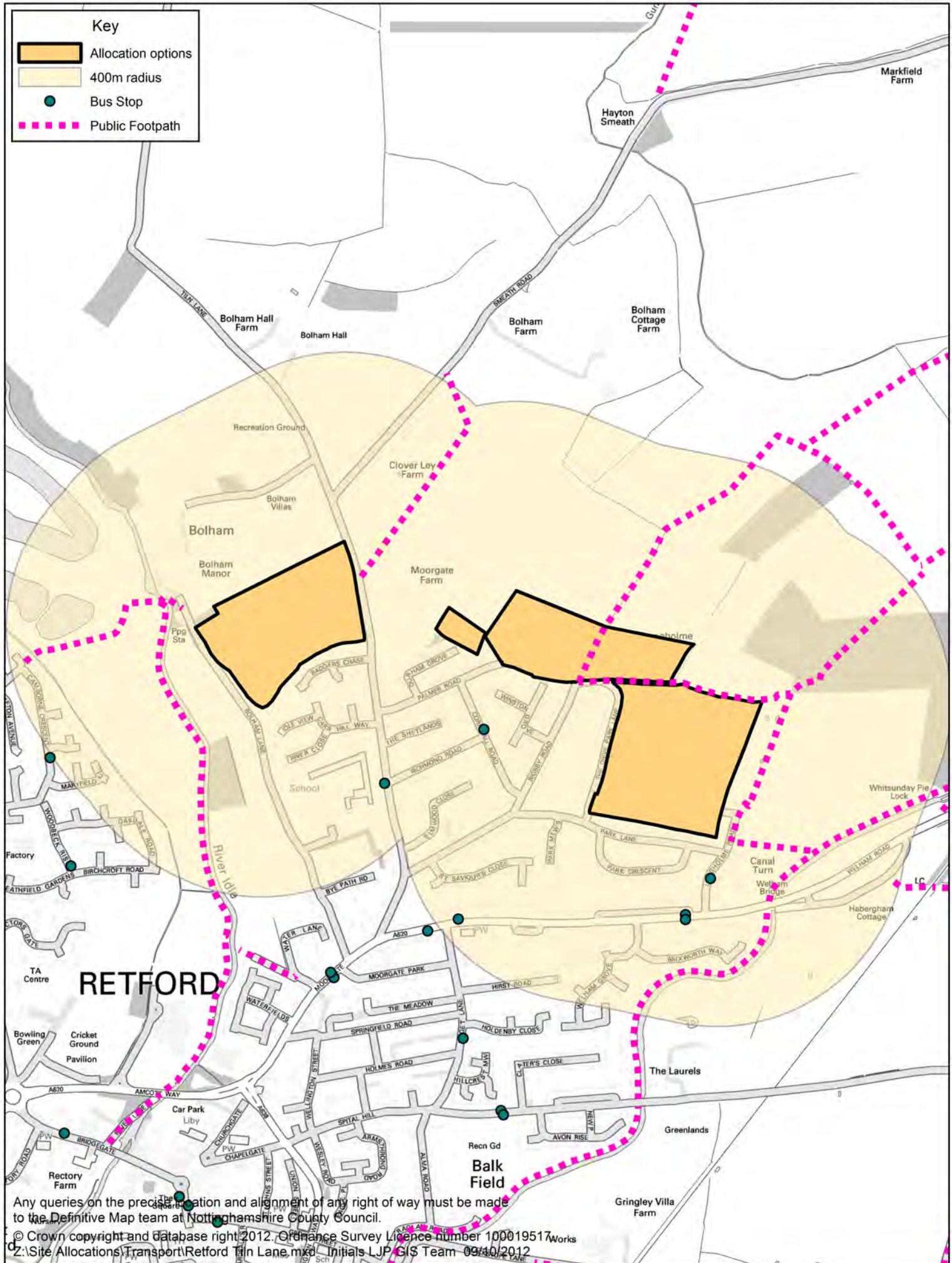





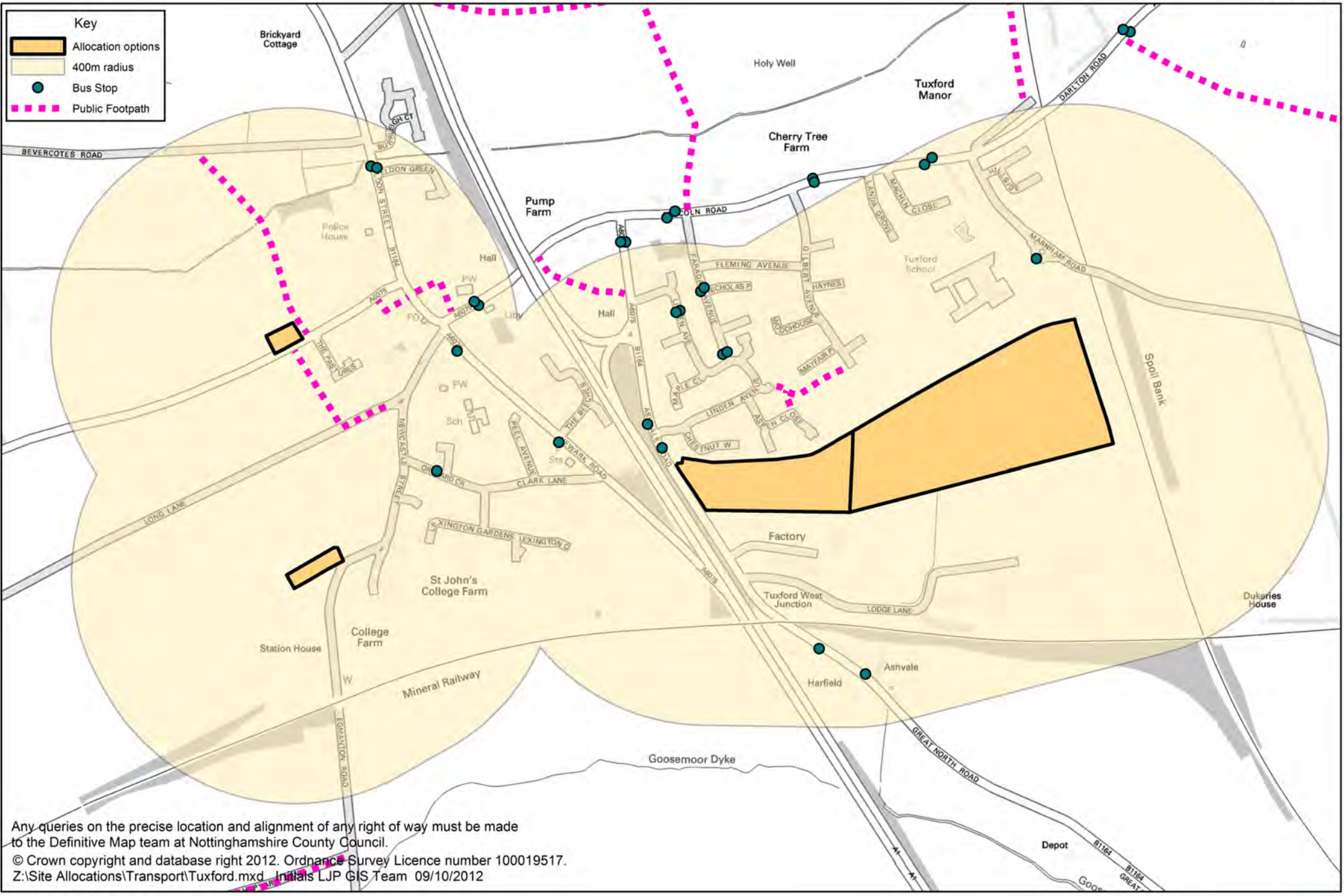

Any queries on the precise location and alignment of any right of way must be made to the Definitive Map team at Nottinghamshire County Council.  
© Crown copyright and database right 2012. Ordnance Survey Licence number 100019517.  
Z:\Site Allocations\Transport\Tuxford.mxd Initials LJP GIS Team 09/10/2012



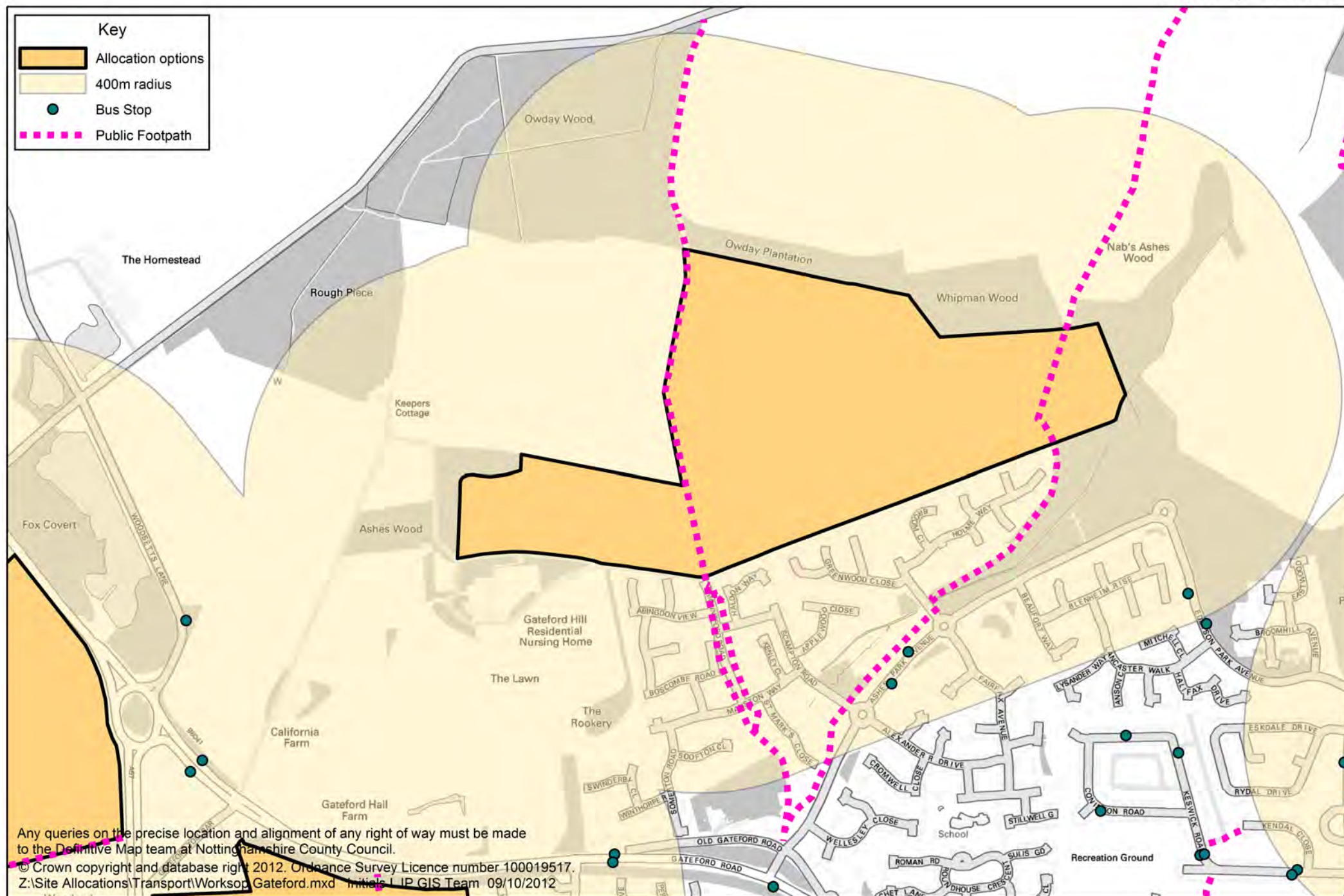



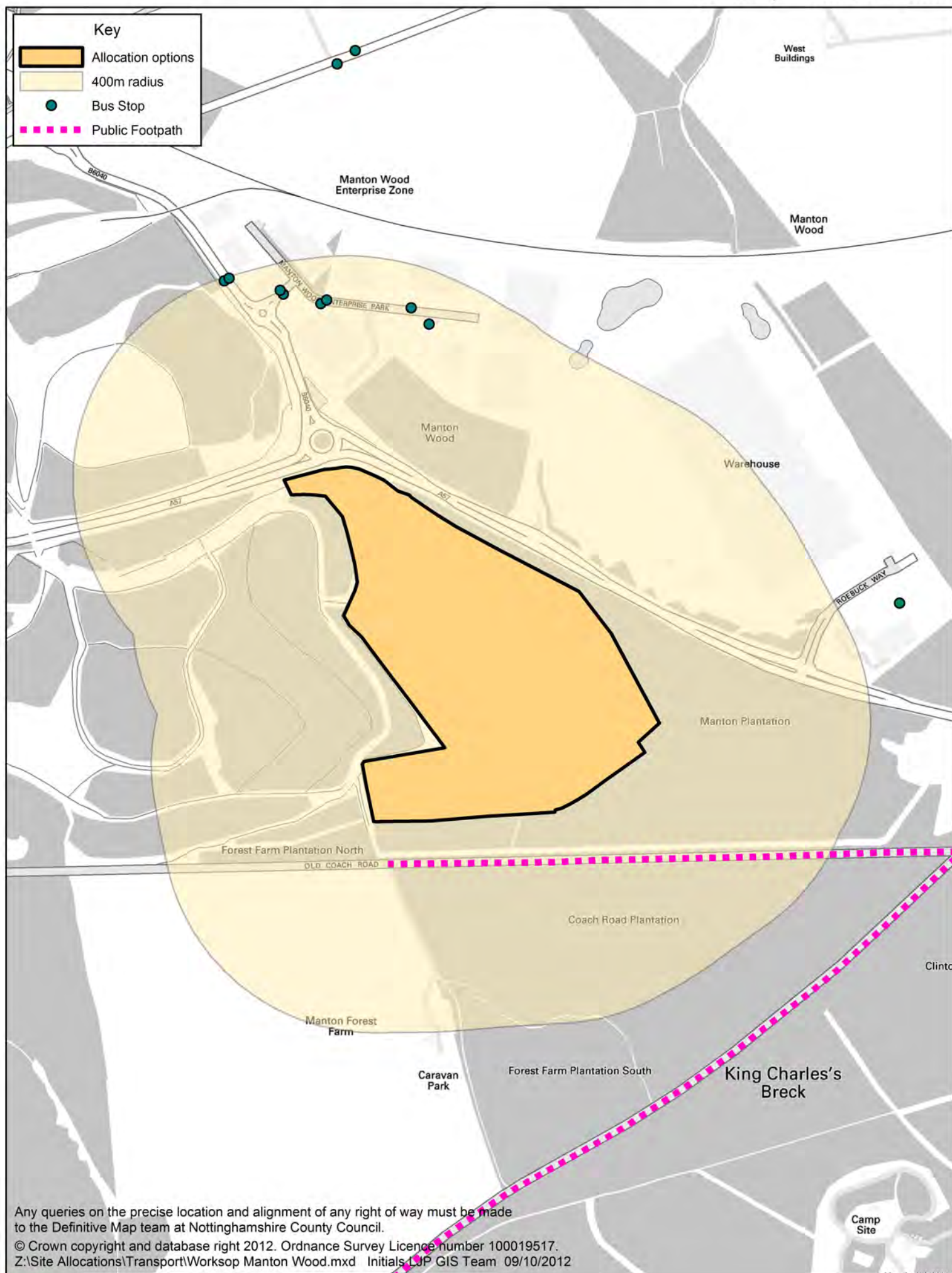



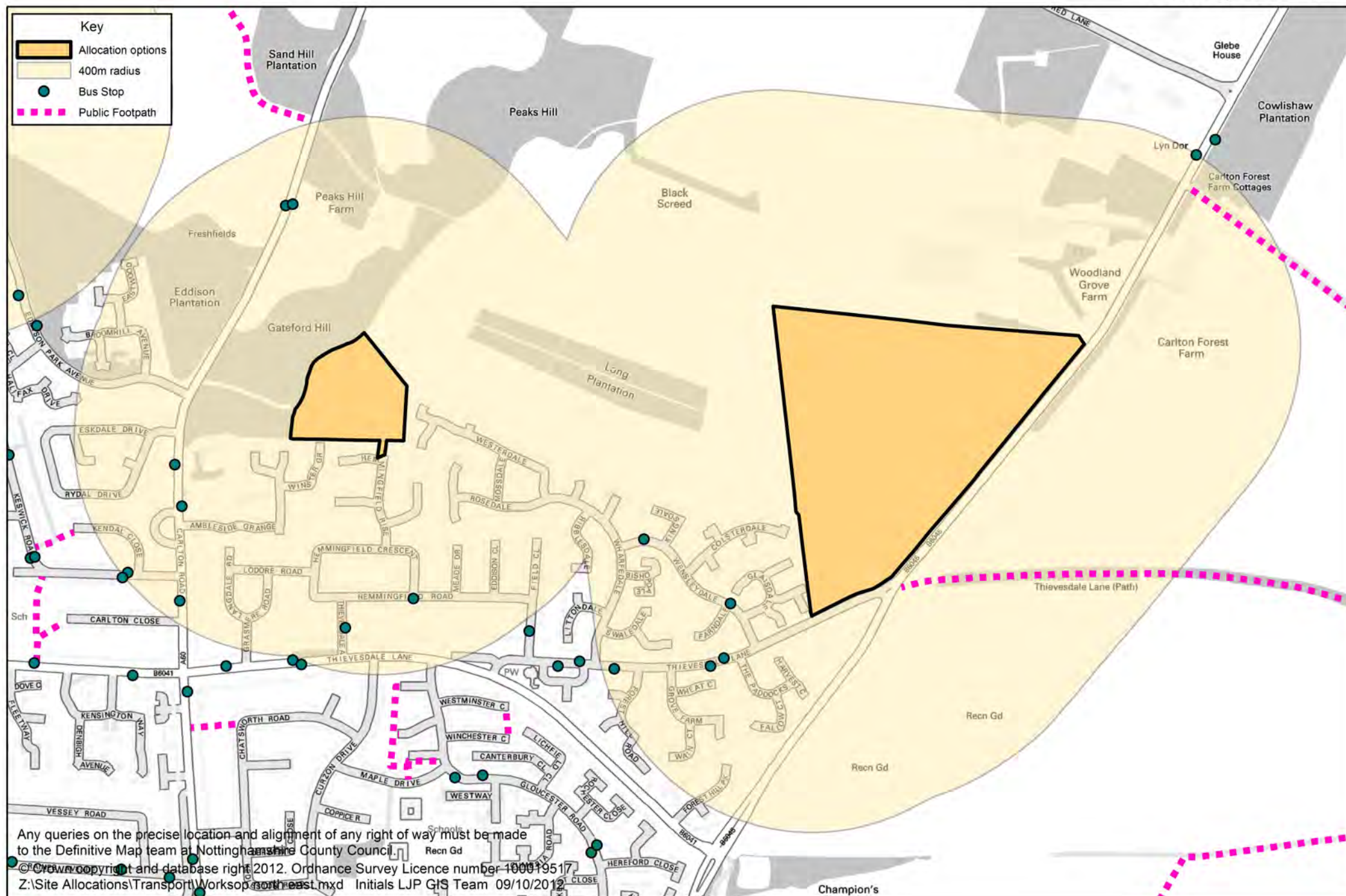







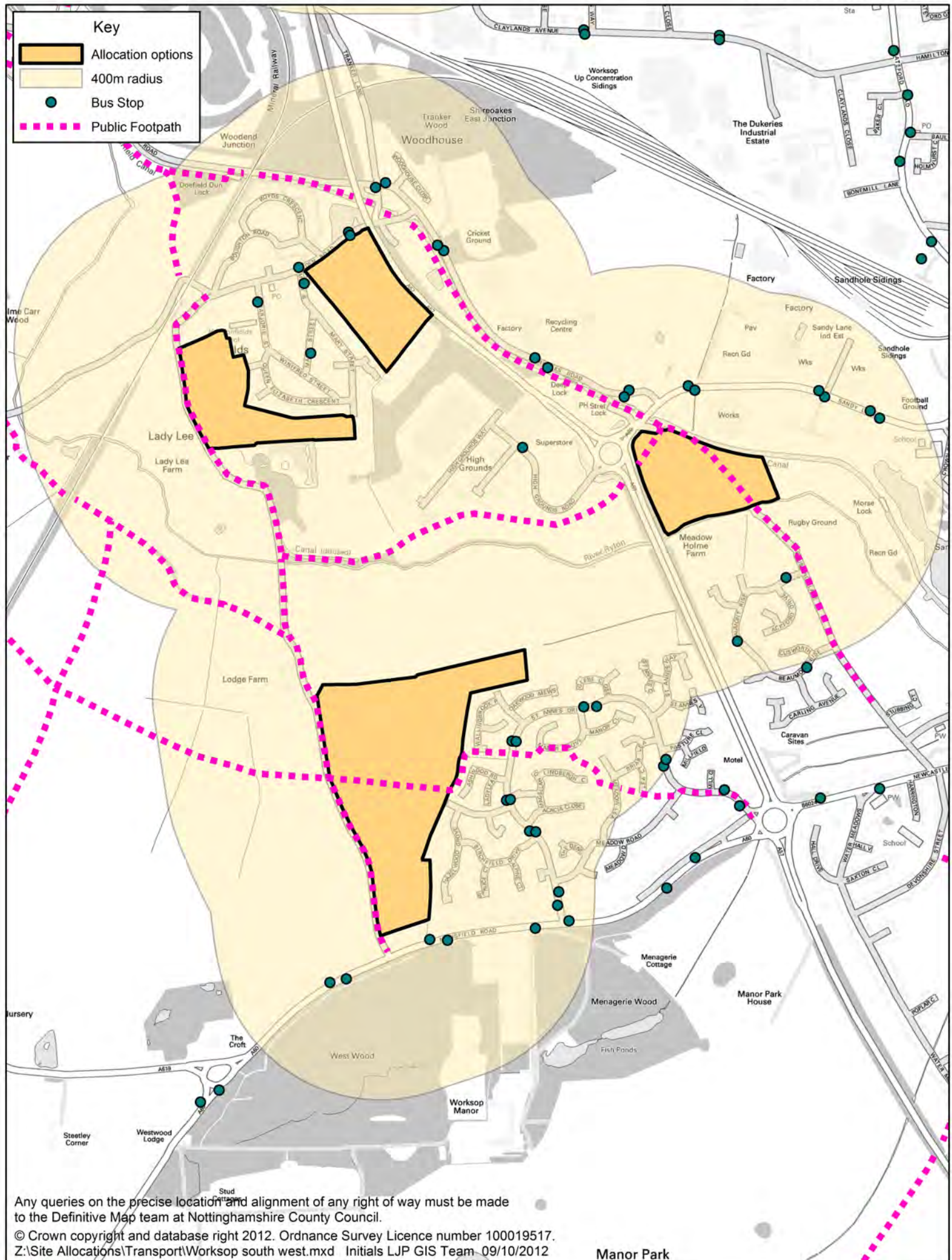

Any queries on the precise location and alignment of any right of way must be made to the Definitive Map team at Nottinghamshire County Council.

© Crown copyright and database right 2012. Ordnance Survey Licence number 100019517.  
Z:\Site Allocations\Transport\Worksop south west.mxd Initials LJP GIS Team -09/10/2012

Manor Park